

**FITTER
(PRACTICAL)
SEMESTER – I**

TIME: 8 HRS.

MARKS: 270

Note: Attempt all questions.

1. Write down the sequence of operations, list of tools, instruments, equipment and safety precautions to be observed for carrying out the job as per the drawing given below. (40)
2. Prepare the job as per drawing given below: (200)

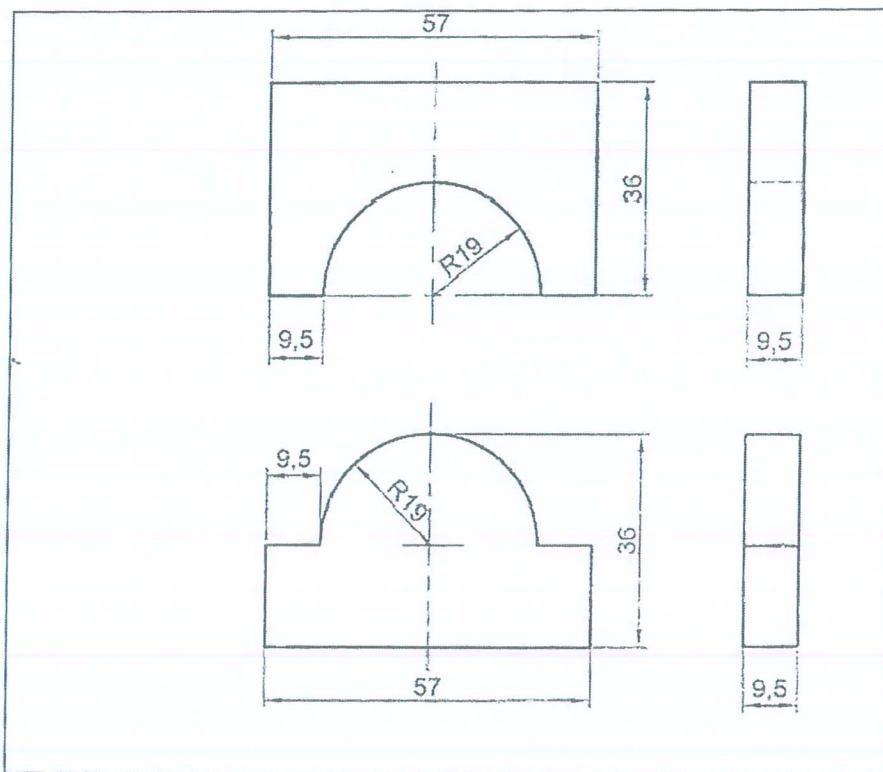

(Note: All dimensions are in mm and general tolerance is +/- 0.02mm.)

3. Viva for basic fitting. (30)
